

10 horses, fowl, - I should require to have permission to keep my stacks on the land until I could thresh and sell the corn - If the Gent. you spoke of or any other is inclined to buy on these terms from which I shall not deviate - I will sell - if not I do not care -

I have annexed a kind of sketch of the Estate - If Gibbins 1200 acres, which may one day be for sale was included in it I think it would not have its equal in the Island -

I remain my dear Sir
Yours truly
Wood

The whole Estate is enclosed with exceedingly good fences - the cultivated paddocks are 40 Acres
The whole is in 12 divisions of diff. size 20
The meadow about 800 Acres may be all put under tillage at expense of about £400 - in banking fences & 24
30
130

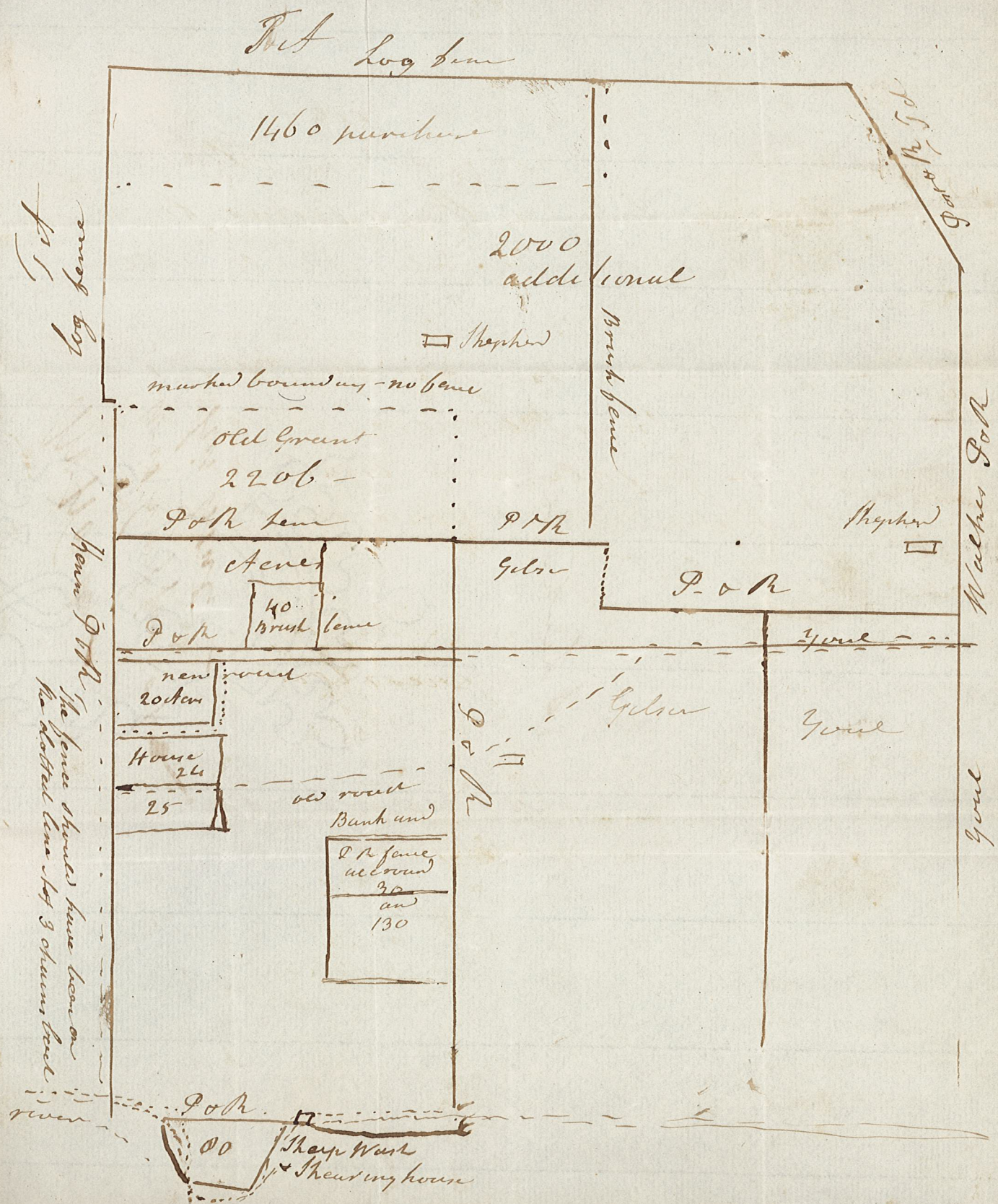

Mr Wood

with respect to
his estate

Dear Sir

Dear Sir

Dear Sir